

SMART TECH

powered by WebOS Hub

50" UHD Smart TV

The 50UW02V is a 4K Ultra High Definition LED TV with exceptional multimedia functionality.



webOS Hub



A World of Premium Content

Smart TVs with webOS deliver what you want, when you want it, hassle-free. News, sports, entertainment, and more - it's all at your fingertips.

Rich library of apps can be downloaded from **App Store**

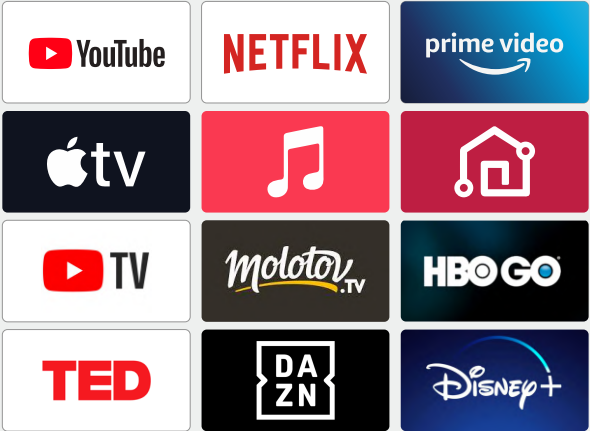

(*Apps availability could be different country by country)

Apple AirPlay

Experience Apple AirPlay in webOS Hub 2.0S powered TVs

Users can now stream movies, music, games, and photos from their iPhone, iPad, or Mac directly to their smart TV using AirPlay on webOS Hub 2.0S.



Apple HomeKit

Experience Apple Ecosystem Here and Now

webOS Hub-powered TVs are compatible with Apple HomeKit technology, enabling users to control their TV using the Apple HomeKit app and Siri.

ThinQ App

New ThinQ App like portal page

Once the user installs LG ThinQ App on the smart phone, the app provides UX in the form of a portal that focuses on content sharing and instant app launching.

Simple Remote Control •

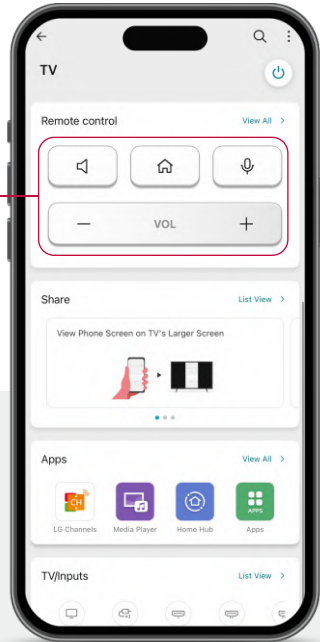

MEMC

Algorithm to overcome the motion blur effect. A 60Hz motion compensation technology (MEMC) detects movement patterns of the objects and apply interpolation between pixels, providing much more smooth video experience.



eARC

HDMI eARC can significantly increase bandwidth and speed. This allows you to send higher-quality audio from your TV to a soundbar or AV receiver.

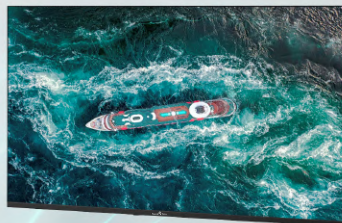

BEZEL-LESS

With the introduction of a new generation optical bonding technology, SmartTech TV frames can be made slimmer. It allows a larger display area while maintaining a neat and contemporary design.

- Wider viewing angles up to 178 degrees
- Immersive viewing experience
- 1mm ultra-slim bezels



4K Ultra High Definition

There are 8.3 million pixels on your 4K UHD TV, which is 4 times more than FULL HD, Enjoy a new level of visuals.



tivùsat is the Italian free to air satellite platform.

tivùsat was created to ensure that everyone has access to the free digital TV. By reaching all areas of the Italian territory, viewers can access all national DTT channels and a huge line up of national and international channels.

Cuboid Speakers

Providing cinematic viewing experience. The new speakers adopted larger drivers that elevate multiple audio experiences, including stronger bass and echo that could amplify your acoustic immersion.

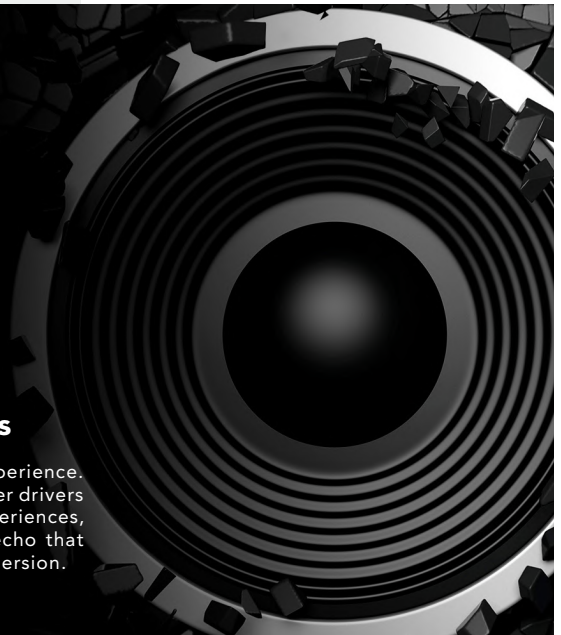



Dolby AUDIO

Amazing sound with Dolby Audio technology. With this technology the TV provides crystal clarity, easy-to-hear dialogue, greater detail, and realistic surround sound to make the entertainment you love even better.

CUBIC SPEAKERS

Providing cinematic viewing experience. The new speakers adopted larger drivers that elevate multiple audio experiences, including stronger bass and echo that could amplify your acoustic immersion.



POWERFUL
PROCESSOR

HIGH
CONFIGURATION

QUAD-CORE
CPU

TRIPLE-CORE
GPU

ARM CA55 *4

Mali G31 MP2

↑ 50%

1.5G
DDR

Larger cache memory
for smooth operation

8G
ROM

More storage for the
APPs you like

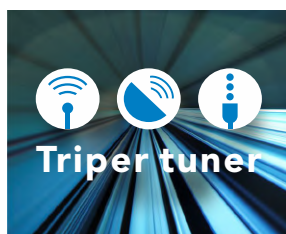

Triper tuner

DVB-T2/S2/C

Cable connection (DVB-C), satellite connection (DVB-S2) and terrestrial television (DVB-T2), it is ideally suited to any existing reception situation thanks to its standard integrated triple tuner and delivers the best possible TV picture depending on the reception type.



Bluetooth 5.1

BLUETOOTH

More convenient by Bluetooth connection to Remote control, earphone, soundbar, smartphone and other Bluetooth devices.

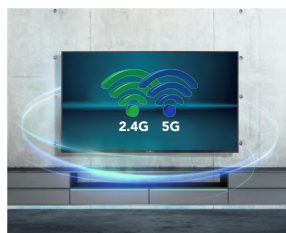

2.4G 5G

2.4G+5G WIFI

Enjoy the rapid and steady WiFi connection under the technology. No more trouble & lag during your movies and shows streaming.



Elegant central U base

Stands safely on a smaller TV shelf, or flexibility places at any corners in the house.

Wall-mountable design

Mount it on the wall to perfectly blend in the interior design.

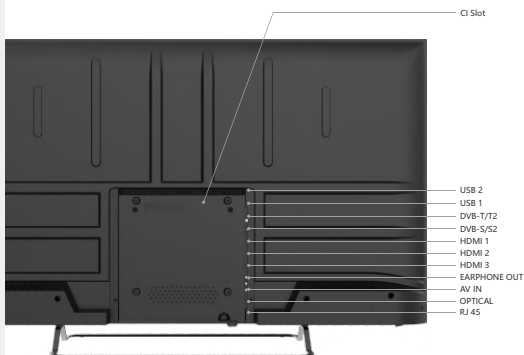

Easy connection

Multi-function connectors on one side, convenient operation

PICTURE

Display technology.....	D-LED
Screen size(inches/cm).....	50/126
Digonal screen size (inches/cm).....	50/126
Panel resolution.....	UHD
Resolution.....	3840*2160
Panel brightness in cd/m ²	260
Active motion.....	60HZ
Dynamic contrast.....	3000:1
Typ.response time in ms (GTG).....	6.5
Aspect ratio.....	16:9
Vision angles.....	178**178°
HDR10 (High Dynamic Range).....	Yes
MEMC.....	Yes

SOUND

Music power output (watts).....	2x10W
Intergrated speakers.....	Yes
Dolby Digital Plus™.....	No
Sound system.....	ATV:BG, DK, I,NICAM/A2 DTV:MPEG-1 layer 1/2 MPEG-2 layer 2/AC3 Standard/Cinema/Clear voice/sport/ music
Sound settings.....	
Audio decoder.....	AC-4
Equaliser.....	Yes(5 Modes)
Dolby Vision.....	No
Dolby Atoms.....	No

Tuner/Broadcasting

DTV Tuner.....	DVB-T/T2/C/S/S2
Video decoding.....	MPEG-2, MPEG-4, H.265.Main@L5.1- 1920*1080@60fps
Analogue tuner.....	IEC
Analogue tuner system.....	PAL, SECAM
CI+ slot.....	1.4
Electronic program guide (EPG).....	7*24 hours
Teletext.....	Yes
Auto channel serach.....	Yes
Channel edit.....	Yes
LCN.....	Yes

OPERATION

Child lock.....	Yes
Sleep timer.....	Yes
Top teletext.....	1000 pages
USB Video.....	MPG, AVI, TS, MOV, MKV, MP4, VOB,AVI,3PG,MPEG
USB Music.....	MP3,M4A,AAC
USB Photo.....	JPG, JPEG, BMP, PNG
USB software update.....	Yes
USB file system.....	FAT16/FAT32/NTFS
USB HID support.....	Yes
Hotel Mode.....	No
Store Mode.....	Yes

SMART FUNCTION

Processor.....	ARM CA55 *4
Operation system.....	Web OS
HbbTV.....	Yes
Smart TV portal.....	Yes
LAN.....	Yes
WiFi.....	Yes
Bluetooth®.....	Yes
Pre-installed apps.....	Yes
DDR.....	1.5G
Internal memory.....	8G
Smartphone/ Tablet remote support.....	Yes
Wifi display(Miracast).....	ThinQ LG
DLNA.....	No
AirPlay.....	Yes
Voice control.....	Yes
Far field.....	No

CONNECTIVITY

HDMI.....	3
HDMI version.....	2.0
HDMI CEC.....	Yes
HDMI ARC.....	Yes
HDMI MHL.....	No
HDCP.....	1.4/2.2
USB 2.0.....	2
USB 3.0.....	0
CI+ slot.....	Yes
RF in (IEC Terrestrial/Cable).....	Yes
RF in (F sat).....	Yes
Scart.....	No
VGA.....	No
Composite/CVBS + Audio In.....	No
Mini AV in.....	No
Digital Audio Out.....	Optical
Headphone.....	Yes
Ethernet(LAN RJ-45).....	Yes
YPbPr.....	No

GENERAL DATA

Brand.....	SMART ⁺ TECH
Model.....	50UW02V
TV Color.....	Matte black
Stand type&color.....	New U3 metal black
Remote control model.....	RC-W01R
Battery type.....	LR03
Power supply.....	AC 100-240V~ 50/60Hz
Standby mode/Off-mode Power consumption.....	Yes
Networked standby mode power consumption.....	No
Energy class (EPREL SDR).....	E
Energy consumption kWh/1000h (SDR) *.....	53W
Energy class (EPREL HDR).....	E
Energy consumption kWh/1000h (HDR) *.....	54W
Annual energy consumption **.....	77kWh
Power consumption working (max.).....	100W
Peak Luminance Ratio.....	65%
Mercury content (mg).....	0
Contains lead (within the legally prescribed limit values).....	Yes
Net size with stand (W x H x D in mm).....	1111.3*691.4*260
Net size without stand (W x H x D in mm).....	1111.3*643.2*76.7
Carton size (W x H x D in mm).....	1210*735*126
Net weight (kg).....	9.10
Gross weight (kg).....	11.90
VESA standard (mm).....	200*200
EAN.....	5999862467357

*The ON-mode power consumption was messured in Eco-mode (factory settings)according to IEC 62087, Edition 2.

The power consumption stated upon the Identification label of the TV-set was determined with maximum settings of all parameters regarding picture brightness

**Annual energy consumptionr, based on the power consumption of the television operating ,4 hours per day for 365 days. The actual energy consumption will depend on how television is used.