

Hisense

Quick Start Guide

PARTY SPEAKER
Model: PARTY STORM
Model: PARTY STORM 1

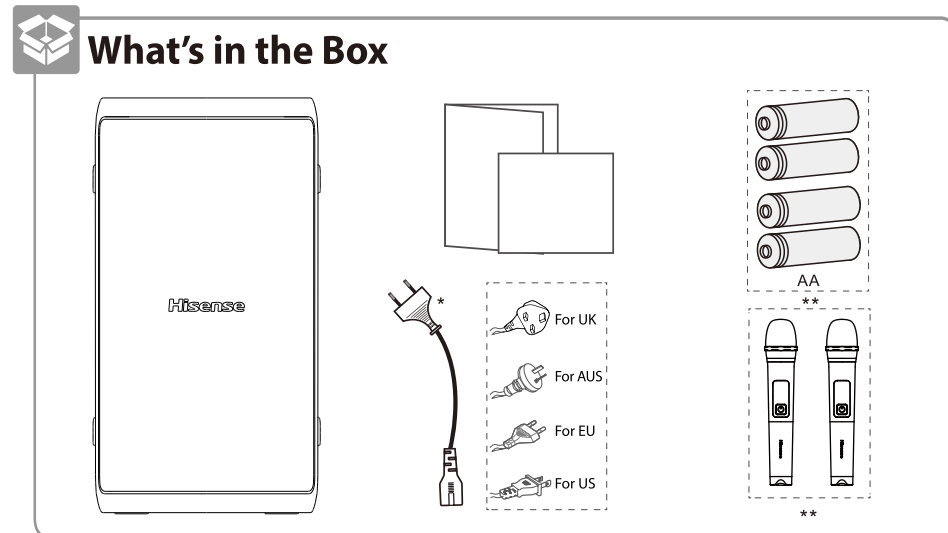
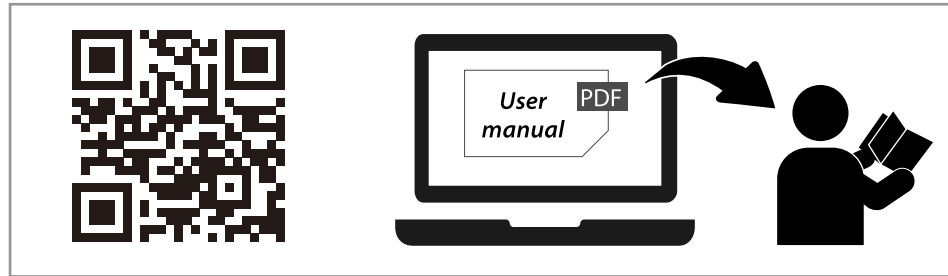
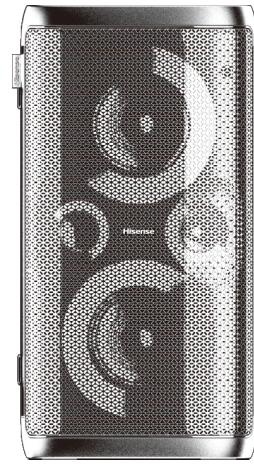

- EN** *Power cord quantity and plug type vary by regions. ** Only for PARTY STORM 1. For other source connections /detailed operation, please refer to Complete UM on web.
- FR** *Le nombre de cordons d'alimentation fournis et le type de prise varient selon les régions.** Uniquement pour le PARTY STORM 1. Pour d'autres connexions de sources ou le fonctionnement détaillé, veuillez vous référer au manuel de l'utilisateur sur le Web.
- DE** *Netzkabel und Steckertyp variieren je nach Region.** nur für PARTY STORM 1. Für andere Anschlüsse von Quellen und eine detaillierte Beschreibung der Bedienung lesen Sie bitte die vollständige Bedienungsanleitung im Internet.
- IT** *La lunghezza del cavo di alimentazione ed il tipo di spina variano in base alla regione.** Solo per il PARTY STORM 1. Per la connessione di altre sorgenti/dettagli sull'utilizzo, fare riferimento al manual completo sul web.
- ES** *La cantidad de cable de alimentación y el tipo de enchufe varían según la región.** Solo para PARTY STORM 1. Para la conexión de otras fuentes/operación detallada, consulte el MU Completo en la web.
- SL** *Število napajalnih kablov in priključki so odvisni od regije.** Le za PARTY STORM 1. V popolnem spletnem priročniku za uporabo so navodila za povezave do drugih virov ter podrobnosti o delovanju/uporabi.
- HR** *Količina kabela za napajanje i vrsta utikača razlikuju se po regijama.** samo za model PARTY STORM 1. Za poveznicе na druge izvore / detaljne informacije o radu pogledajte cijeli korisnički priručnik na mreži.
- CZ** *Počet napájecích kabelů a typ zástrčky se liší podle regionu.** jen pro PARTY STORM 1. Připojení k jiným zdrojům nebo podrobné informace o používání najdete v kompletní uživatelské příručce na webu.
- SK** *Dĺžka napájacieho kábla a typ zástrčky sa líšia v závislosti od regiónu.** Len pre PARTY STORM 1. Pripojenia k iným zdrojom/podrobné informácie o obsluhu nájdete v Kompletnej používateľskej príručke na webe.
- HU** *Az áramkábel hossza és a dugvilla típusa régióként eltérő.** Csak PARTY STORM 1 esetén. Más forrásokhoz való csatlakozáshoz/részletezett kezeléshoz tekintse meg a teljes felhasználói kézikönyvet az Interneten.
- PT** *A quantidade de cabo de alimentação e o tipo de fcha variam de acordo com a região.** Apenas para PARTY STORM 1. Para outras ligações de entradas/função detalhada, consulte o MU Completo na Internet.
- RO** *Cantitatea de cabluri de alimentare și tipul de ștecher variază în funcție de regiune.** numai pentru PARTY STORM 1. Pentru conectarea la alte surse/funcționarea detaliată, vă rugăm să consultați manualul complet de utilizare disponibil online.
- PL** *Liczba kabli zasilających i wtyczek zależy od regionu.** Tylko dla PARTY STORM 1. Informacje na temat połączeń z innymi źródłami lub szczegółowej obsługi można znaleźć w pełnej instrukcji obsługi dostępnej w Internecie.
- RU** *Количество шнуров питания и тип вилки зависят от региона.** только для PARTY STORM 1. Информацию о подключении других источников / подробное описание работы см. В полном руководстве пользователя в Интернете.
- SR** *Broj strujnih kablova i vrste utikača variraju u zavisnosti od regiona.** Samo za PARTY STORM 1. Za druga povezivanja izvora / detaljni rad, pogledajte kompletno korisničko uputstvo na internetu.
- MK** *Должината на електричниот кабел и типот на приклучок се разликуваат според регионите.** Само за PARTY STORM 1. За други поврзувања на изворот / детални операции, погледнете го целосното КУ на веб.
- SQ** *Sasia e kordonit elektrik dhe lloji i spinës ndryshojnë sipas rajoneve.** Vetëm për PARTY STORM 1. Për lidhje të tjera të burimit / funksionim të detajuar, referohuni te ""Manuali i plotë i përdoruesit në ueb.
- BS** *Količina napojnog kabela i utikač razlikuju se u zavisnosti od regiona.** Samo za PARTY STORM 1. Za spajanje drugih izvora / detaljne podatke o radu pogledajte čitav priručnik na mreži.
- GR** *Ο αριθμός των καλωδίων ρεύματος και ο τύπος του φις διαφέρουν ανάλογα με την περιοχή. Μόνο για το PARTY STORM 1. / λεπτομερή λειτουργία, ανατρέξτε στο Πλήρες εγχειρίδιο χρήσης στο διαδίκτυο.
- BG** *Количеството захранващи кабели и типът на щепсела са различни в различните региони. Само за PARTY STORM 1. / подробности указания за експлоатация, моля, направете справка с Пълното ръководство на потребителя в интернет.
- KAZ** *Қуат сымның саны мен аша түрі аймақтарға байланысты ерекшеленеді. тек PARTY STORM 1 үшін. / толық пайдалану жағдайларын интернеттегі UM толық нұсқасынан қараңыз.

تختلف كمية سلك الطاقة ونوع القابس حسب المنطقة. * فقط ل PARTY STORM 1 **AR**

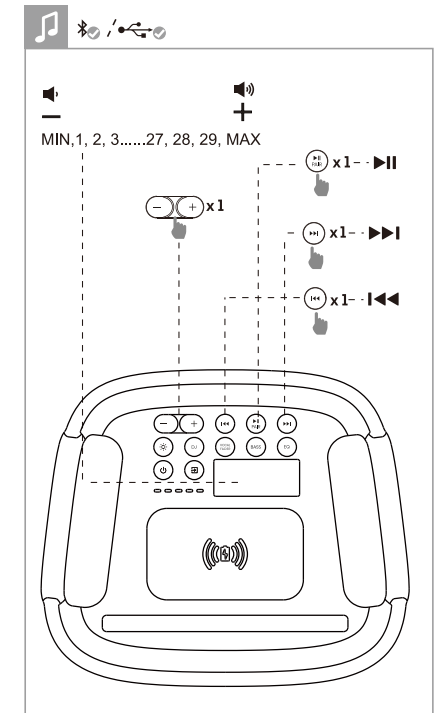
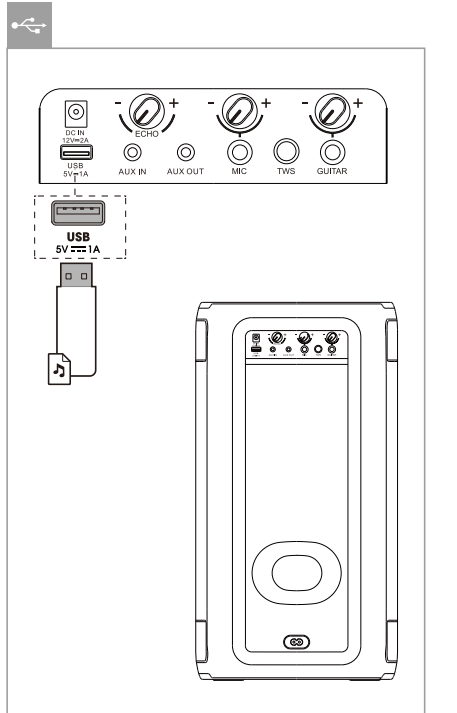
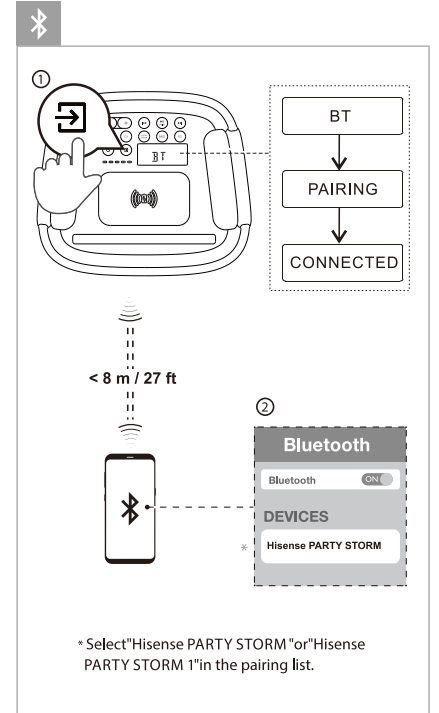
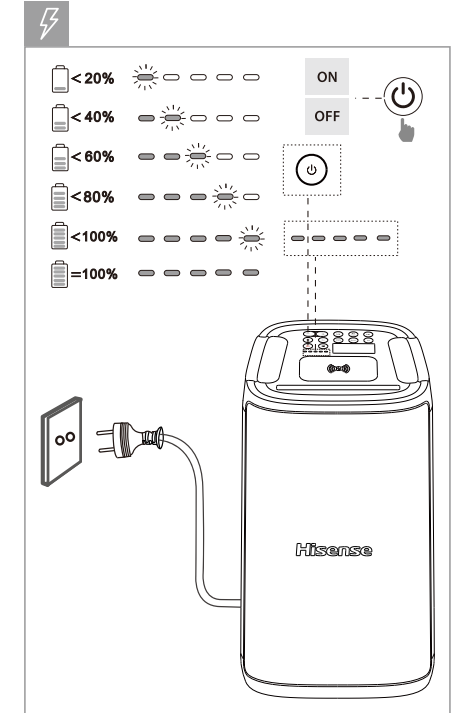

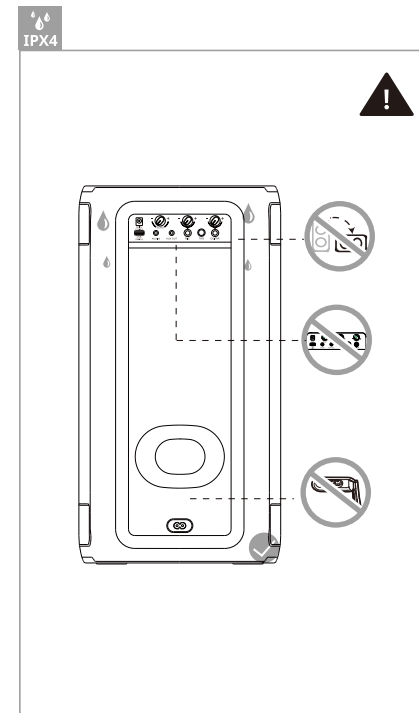
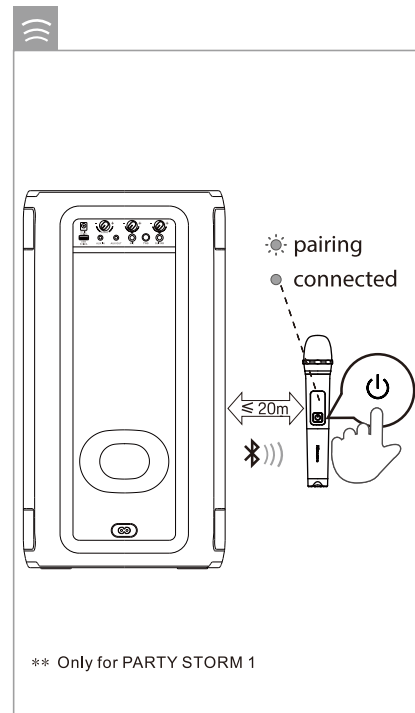
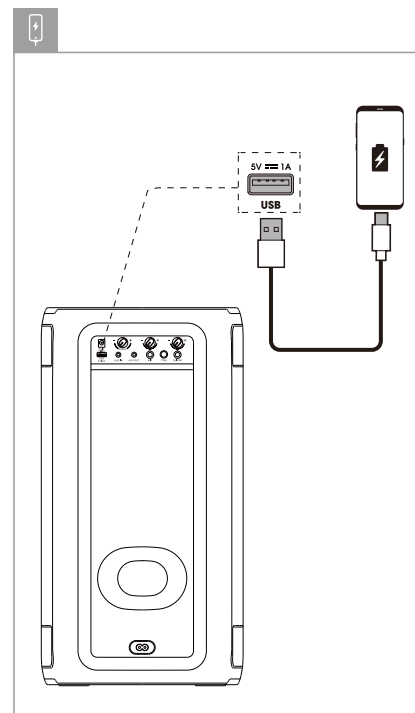
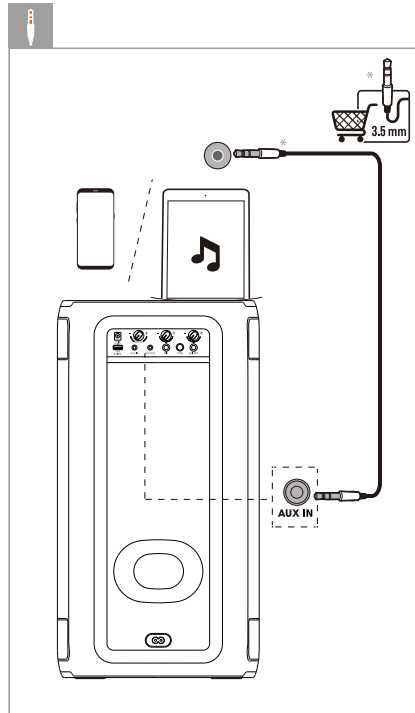
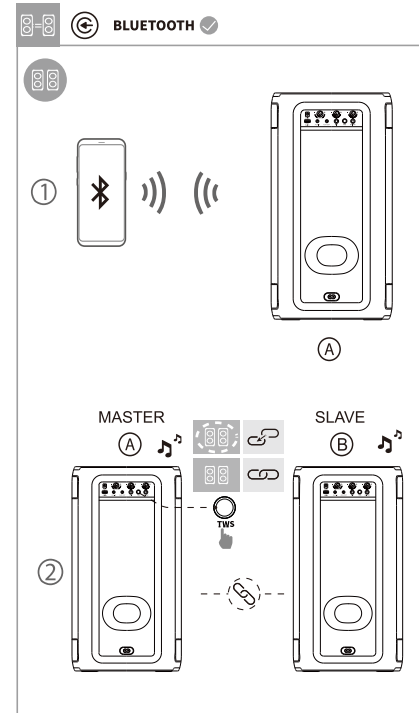
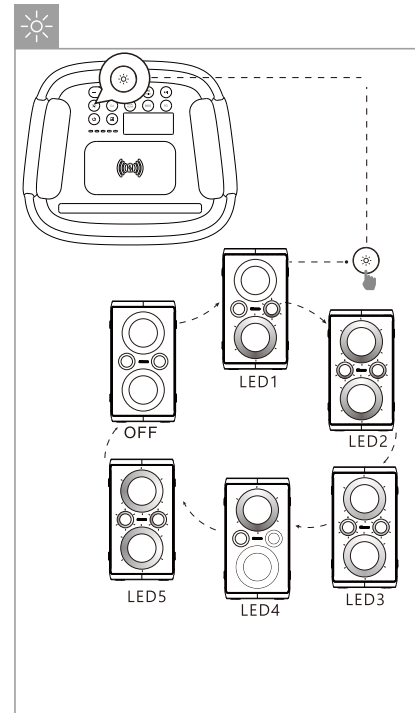
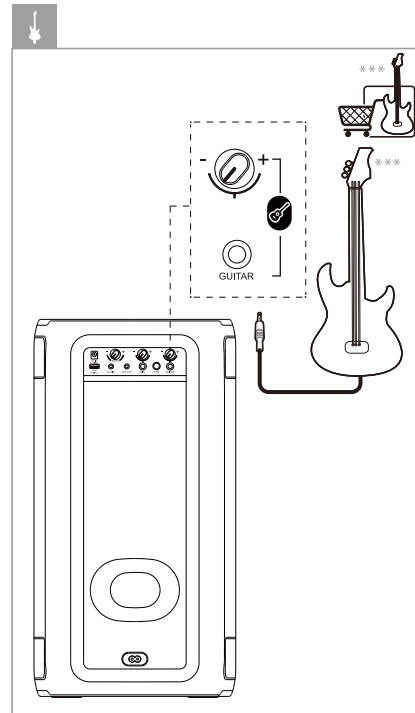
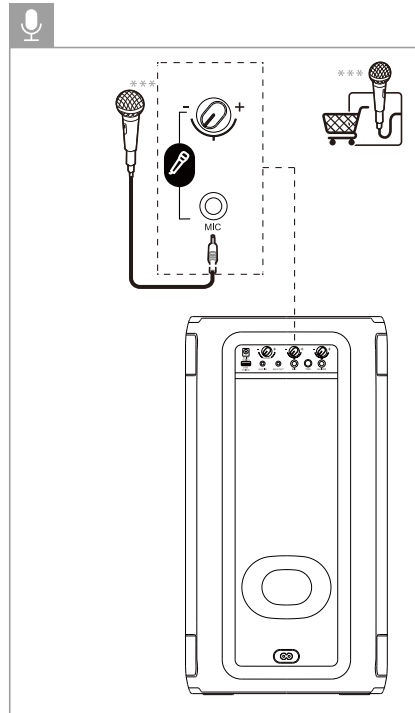

** Only for PARTY STORM 1

TRADEMARK



The Bluetooth® word mark and logos are registered trademarks owned by Bluetooth SIG, Inc. We are the licensee to use such marks. Other trademarks and trade names are those of their respective owners.



EU Declaration of conformity (DoC)

Unique identification of this DoC: H-GJYX-20240815-001

We, Declare under our sole responsibility that the product:

Product Name: Audio Equipment

Trade Name: Hisense

Model: PARTY STORM , PARTY STORM 1

To which this declaration relates is in conformity with the essential requirements and other relevant requirements of the radio equipment directive (2014/53/EU), Eco design Directive (2009/125/EC) & Regulation(EU) 2023/826, RoHS Directive (2011/65/EU and its amendment (EU)2015/863

The product is in conformity with the following standards and /or other normative documents:

Health & Safety (Art. 3(1)(a)): EN62479:2010, EN 50663:2017, EN IEC 62311: 2020, EN 50665:2017, EN IEC 62368-1:2020+A11:2020

EMC (Art. 3(1)(b)): EN 55032: 2015/A1:2020, EN 55035:2017/A11:2020
 EN IEC 61000-3-2:2019, EN 61000-3-3:2013/A1:2019
 ETSI EN 301 489-1 V2.2.3: 2019, ETSI EN 301 489-3 V2.1.1: 2019, ETSI EN 301 489-17 V3.2.4: 2020
 Spectrum (Art. 3(2)): ETSI EN 300 328 V2.2.2: 2019, ETSI EN 300 440 V2.2.1:2018 (For PARTY STORM1 Only), ETSI EN 303 417 V1.1.1: 2017

ErP: COMMISSION REGULATION (EU) 2023/826, IEC 62087-1:2015, IEC 62087-6:2015, EN 50564: 2011,

RoHS: 2011/65/EU and its amendment (EU)2015/863

Place and date of issue (of this DoC): Hong Kong, China; 2024-8-15

Signed by or for the manufacturer: XinYang (Hong Kong) Co., Ltd

Address: Room3101-05, Singga Commercial Centre.No.148 Connaught Road West, Hong Kong,China

Title: Quality & Compliance Manager

Name (in print): Jack Zhao

Signature: *Jack Zhao*

