

USER MANUAL

CS300



SCAN for more

User Manual
Manual del usuario
Benutzerhandbuch
Manuale Utente
Manuel d'utilisation
取扱説明書



A l l A b o u t P a s s i o n

Product Accessories

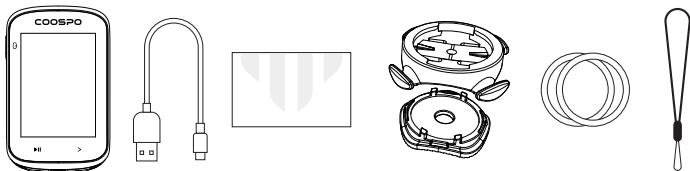

Charging

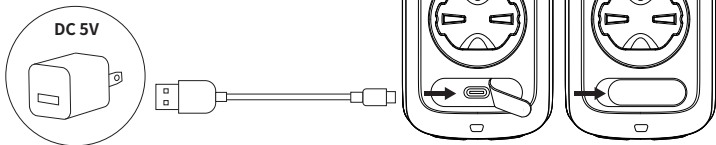

How to Install

1

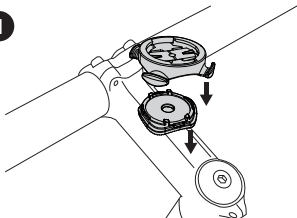

2

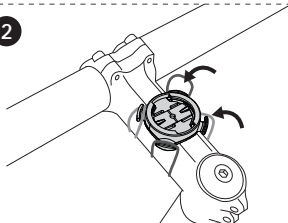

3

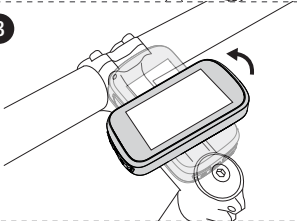

4

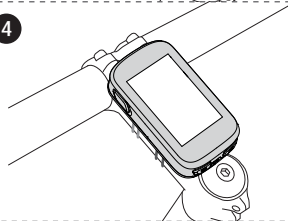

Common wheel size and circumference(Wheel Size L (mm))

| | | | |
|------------------------------|--------------------------|--------------------------|----------------------------|
| <u>12 × 1.75 935mm</u> | <u>24 × 2.00 1925mm</u> | <u>26 × 1.40 2005mm</u> | <u>700 × 18C 2070mm</u> |
| <u>14 × 1.5 1020mm</u> | <u>24 × 2.125 1965mm</u> | <u>26 × 1.50 2010mm</u> | <u>700 × 19C 2080mm</u> |
| <u>14 × 1.75 1055mm</u> | <u>26 × 1.75 2023mm</u> | <u>27 × 1 2145mm</u> | <u>700 × 20C 2086mm</u> |
| <u>16 × 1.5 1185mm</u> | <u>26 × 1.95 2050mm</u> | <u>27 × 1-1/8 2155mm</u> | <u>700 × 23C 2096mm</u> |
| <u>16 × 1.75 1195mm</u> | <u>26 × 2.00 2055mm</u> | <u>27 × 1-1/4 2161mm</u> | <u>700 × 25C 2105mm</u> |
| <u>18 × 1.5 1340mm</u> | <u>26 × 2.10 2068mm</u> | <u>27 × 1-3/8 2169mm</u> | <u>700 × 28C 2136mm</u> |
| <u>18 × 1.75 1350mm</u> | <u>26 × 2.125 2070mm</u> | <u>27.5×1.75 2114mm</u> | <u>700 × 30C 2170mm</u> |
| <u>20 × 1.75 1515mm</u> | <u>26 × 2.35 2083mm</u> | <u>27.5×2.125 2174mm</u> | <u>700 × 32C 2155mm</u> |
| <u>20 × 1-3/8 1615mm</u> | <u>26 × 3.00 2170mm</u> | <u>27.5×1.5 2074mm</u> | <u>700C Tubular 2130mm</u> |
| <u>22 × 1-3/8 1770mm</u> | <u>26 × 7/8 1920mm</u> | <u>27.5×1.95 2146mm</u> | <u>700 × 35C 2168mm</u> |
| <u>22 × 1-1/2 1785mm</u> | <u>26 × 1(59) 1913mm</u> | <u>29×2.1 2288mm</u> | <u>700 × 38C 2180mm</u> |
| <u>24 × 1 1753mm</u> | <u>26 × 1(65) 1952mm</u> | <u>29×2.2 2298mm</u> | <u>700 × 40C 2200mm</u> |
| <u>24×3/4 Tubular 1785mm</u> | <u>26 × 1.25 1953mm</u> | <u>29×2.3 2326mm</u> | <u>700 × 42C 2224mm</u> |
| <u>24 × 1-1/8 1795mm</u> | <u>26 × 1-1/8 1970mm</u> | <u>650× 35A 2090mm</u> | <u>700 × 44C 2235mm</u> |
| <u>24 × 1-1/4 1905mm</u> | <u>26 × 1-3/8 2068mm</u> | <u>650 × 38A 2125mm</u> | <u>700 × 45C 2242mm</u> |
| <u>24 × 1.75 1890mm</u> | <u>26 × 1-1/2 2100mm</u> | <u>650 × 38B 2105mm</u> | <u>700 × 47C 2268mm</u> |

Table of Contents

| | |
|----------------|----|
| English | 1 |
| Español | 13 |
| Deutsch | 23 |
| Italiano | 33 |
| Français | 43 |
| 日本語 | 53 |



For more product details

please visit: www.coospo.com/faq

Button Function

ⓘ For the first time use, please charge the device.



| Button | Function |
|---|---|
| ①  | Power on/off: Short Press - On Long Press - Off Riding: Short Press - Lap Settings: Short Press - Save and return |
| ②  | Short Press - Start/Stop Long Press - Save Settings: Short Press - Confirm |
| ③  | Short Press - Page Switch Long Press - Enter Settings |

Icons

| | |
|-------------|-------------------------------|
| | GPS signal on |
| | No GPS signal |
| | GPS off, no signal |
| | Battery |
| | Start/Ride |
| | Stop |
| | Auto-Pause |
| | Indoor Ride |
| | Bluetooth Connection with App |
| AVG | Average |
| MAX | Max |
| %MAX | Percentage of max |
| mph | Miles per hour |
| km/h | Kilometers per hour |
| | Speed above average |
| | Speed below average |

| | |
|-------------|--|
| | Speed sensor connected |
| | Heart Rate Monitor |
| | Speed Sensor |
| | Cadence Sensor |
| | Power |
| ODO | Odometer |
| DST | Distance |
| AST | Ascent |
| GRA | Gradient |
| CAL | Calorie |
| LAP | Lap |
| | Power Meter |
| UTC | Time zone |
| ALT | Altitude |
| °C°F | Temperature: may vary from actual environment. |

Data Page

Dynamic Zone Chart

The Dynamic Zone Chart shows the current zone of data. For example, if the current speed is 25.6km/h, then you are in zone 3 of speed.

Speed zone, cadence zone, heart rate zone, and power zone can be set in CoospoRide > Devices > CS300 > ALL Settings > My Profile.

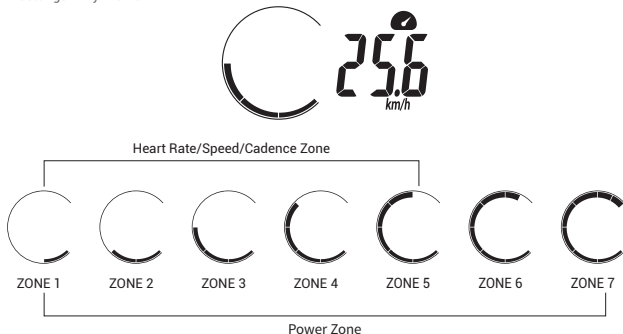

Customize Pages

Page ①: Speed, Time, Distance, Gradient, Altitude

Page ②: Speed, Power, Cadence, Heart Rate, Ascent

Page ③: Average Speed, Time, Average Altitude, Average Gradient, Distance

Page ④: Max Speed, Time, Calories, Temperature, Distance

Page ⑤: Speed, Time, Distance, Gradient, Odometer

Note: Page ⑤ is closed by default; please enable in CoospoRide > Devices > Page Settings;
Page data can be customized in CoospoRide APP.

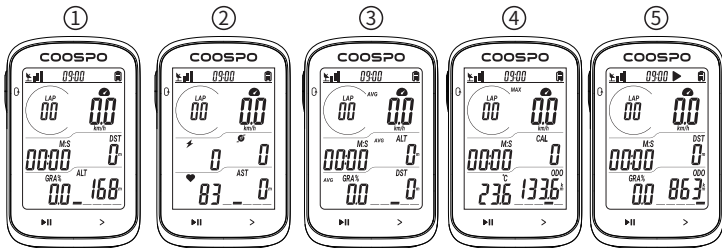

Device Settings

Long press > for 2 seconds to access settings, Setting page blinks to indicate that it is on the current page. short press > to switch between P1-P5, and short press ▶|| to enter current settings.

Note: Settings will be automatically saved and exited after 10 seconds of no button operation.

Setting ① : Add Sensor

The device automatically recognizes and adds sensors.

Searching: icons and data flash;

Connected: icons and data are always on;

Short press ① to save and return.

❗ Check sensor compatibility: www.coospo.com/faq

Add sensors in the app:

Open CoospoRide > Devices > CS300 > Add Sensor.

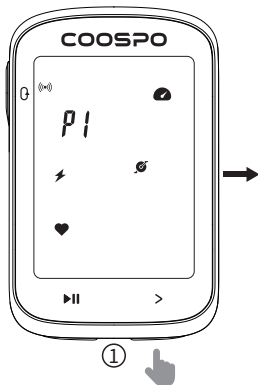

Setting ② : Time Zone

Short press > to add time zones;

Short press ►|| to confirm current digit and set the next digit;

Short press 0 to save and return.



Setting ③ : Wheel Size



Short press > to add values;

Short press ►|| to confirm the current digit and set the next digit;

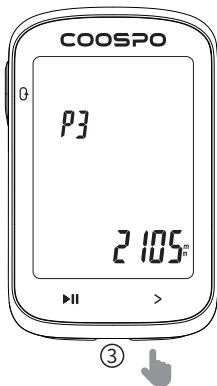
Short press 0 to save and return.



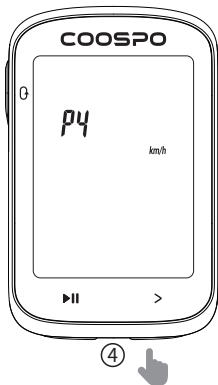

Setting ④: Unit Settings

Short press  to enter unit settings;
Short press  to switch between metric/ imperial units.
Short press  to save and return.



Setting ⑤: Power Calibration

Short press  to enter power calibration;
Short press  to calibrate the power sensor.
Short press  to save and return.

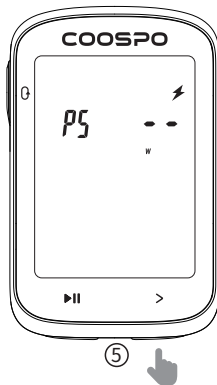

Ride

GPS Positioning

1. For the initial satellite positioning, please wait 30-90 seconds in an open outdoor area. The date and time of the device will be set automatically after the initial positioning is successful.
2. To get the best satellite signal, please ensure that the bike computer remains stationary while it acquires the GPS signal.

Start:

Short press  for a 3-2-1 countdown on the data page, begin your ride with the start icon displayed.

Lap:

Short press  to mark a lap after starting ride. Lap displays for 10 seconds; any key press cancels the lap.

Pause/Auto-Pause:

Short press  to pause the ride. Press  again to resume the ride .

If you enable the auto-pause, the ride pauses when you stop moving or when the speed falls below the value you set. This feature prevents undesired data recording during stops, rests, or while walking the bike.

Save:

Long press  to save the ride.

Check Data:

Press  to switch pages and review the data from your last ride.

More Data: Check more detailed activity data on CoospoRide APP.

Connect to CoospoRide APP

- !** Please do not pair the bike computer at your phone's Bluetooth settings.
Please download CoospoRide APP in Apple Store or Google Play;
Enable the Bluetooth and location permissions on your phone;
CoospoRide APP > Bike Computer > Add Device > CS300 > Click on Device ID to connect the bike computer.
- !** Please ensure that Bluetooth and location permissions are enabled for the app before connecting. Some phone models may not be able to search for Bluetooth devices without authorization.

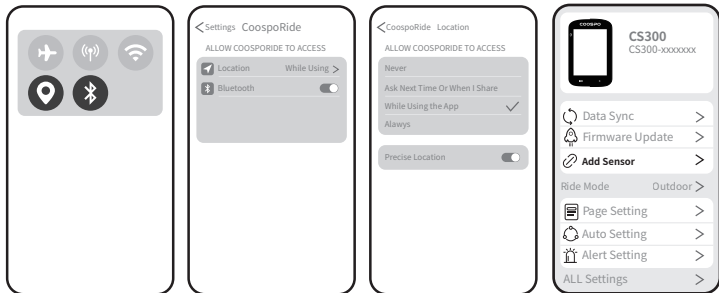

Contact us



Website: www.coospo.com



E-mail: support@coospo.com

Attentions

The information contained in this manual is for reference only. The product described above may be subject to alteration owing to the manufacturer's continuing research and development plans without prior notice.

Disclaimer

The information contained in this manual just for reference. The product described above may be subject to alteration owing to the manufacturer's continuing research and development plans, without making an announcement in advance.

We shall not bare any legal responsibility for any direct or indirect, accidental or special damages, losses and expenses arising from or in connection with this manual or the contained product.

FCC statement

NOTE: This equipment has been tested and found to comply with the limits for a Class B digital device, pursuant to part 15 of the FCC Rules. These limits are designed to provide reasonable protection against harmful interference in a residential installation. This equipment generates, uses and can radiate radio frequency energy and, if not installed and used in accordance with the instructions, may cause harmful interference to radio communications. However, there is no guarantee that interference will not occur in a particular installation. If this equipment does cause harmful interference to radio or television reception, which can be determined by turning the equipment off and on, the user is encouraged to try to correct the interference by one or more of the following measures:

- Reorient or relocate the receiving antenna.
- Increase the separation between the equipment and receiver.
- Connect the equipment into an outlet on a circuit different from that to which the receiver is connected.
- Consult the dealer or an experienced radio/TV technician for help

Changes or modifications not expressly approved by the party responsible for compliance could void the user's authority to operate the equipment.

This device complies with Part 15 of the FCC Rules. Operation is subject to the following two conditions:

(1) this device may not cause harmful interference, and (2) this device must accept any interference received, including interference that may cause undesired operation.

IC WARNING

This device contains licence-exempt transmitter(s)/receiver(s) that comply with Innovation, Science and Economic Development Canada's licence-exempt RSS(s). Operation is subject to the following two conditions:

- (1) This device may not cause interference.
- (2) This device must accept any interference, including interference that may cause undesired operation of the device.

L'émetteur/récepteur exempt de licence contenu dans le présent appareil est conforme aux CNR d'Innovation, Sciences et Développement économique Canada applicables aux appareils radio exempts de licence. L'exploitation est autorisée aux deux conditions suivantes :

- (1) L'appareil ne doit pas produire de brouillage;
- (2) L'appareil doit accepter tout brouillage radioélectrique subi, même si le brouillage est susceptible d'en compromettre le fonctionnement.



Waste electrical products should not be disposed of with household waste. Please recycle where facilities exist. Contact your local government or a retailer for additional information.



- Do not open or modify the product.
- Do not disassemble or attempt to service this product.
- This product is safe under normal and reasonably foreseeable operating conditions.
- If product is operating improperly, call COOSPO support.
- Product must be returned to the manufacturer for any service or repair.