

PTV 65GQU-5025C (数字)

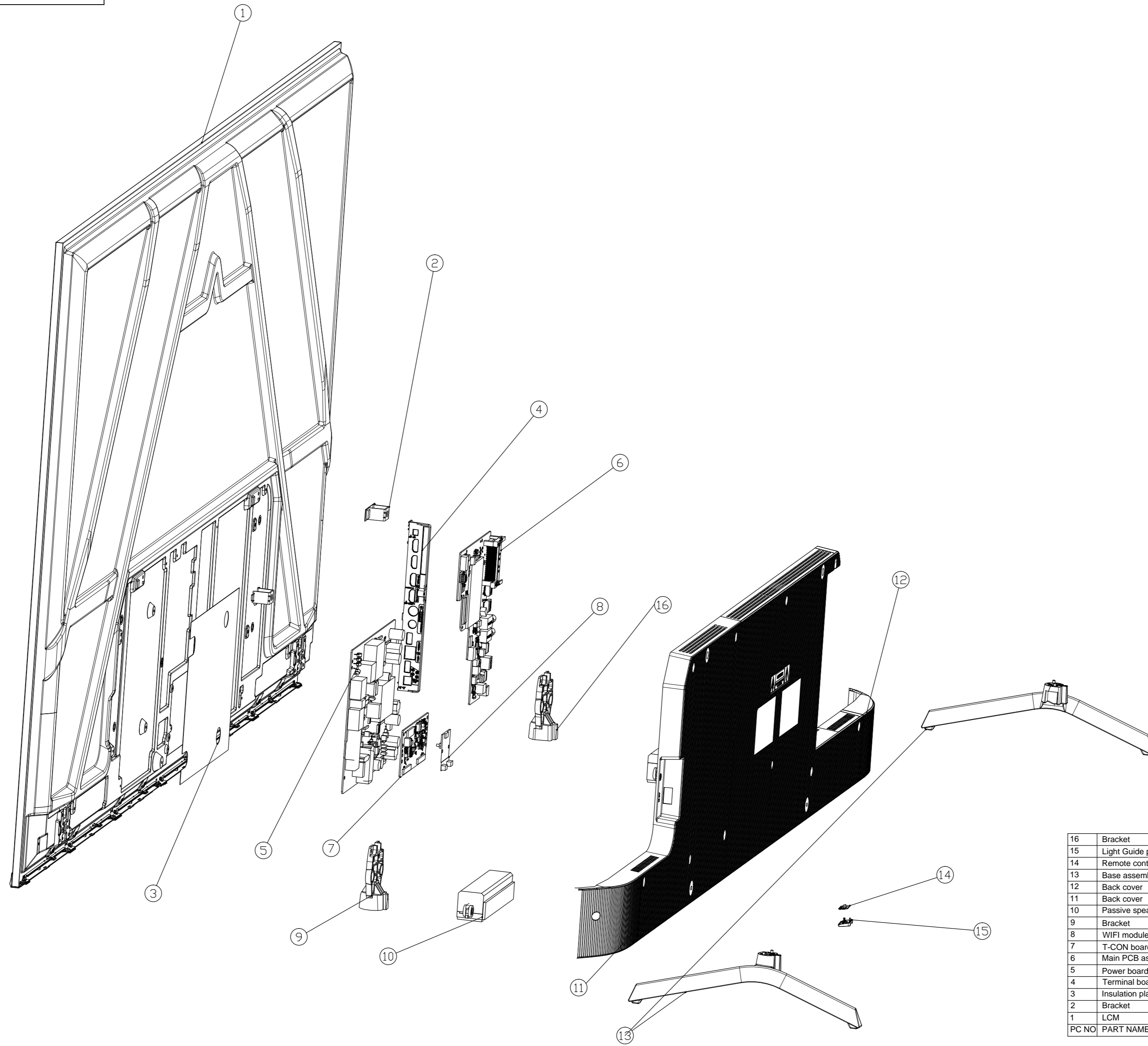

16	Bracket	950220554	BKP-DZ65M10-L0-000000	
15	Light Guide pillar	850312670	JUC8.640.00274593-2	
14	Remote control PCB assembly	850307912	JUC6.695.00292225(BZ)	
13	Base assembly	950222154	BEA-DFM0H0-00-00L015(ESP)	1
12	Back cover	950215912	BCP-65M10GP-L0-050000	1
11	Back cover	950230612	BCP-65M10GP-R0-08L000	1
10	Passive speakers	950216865	YX15033-A1-12W-6Q-PHS	1
9	Bracket	950220555	BKP-DZ65M10-R0-000000	1
8	WiFi module	850317990	AL-7663B-WG-A	1
7	T-CON board	950085705	TCA-SOC-H-U65-0072	2
6	Main PCB assembly	950239853	MBA-GTM9603-UTS-D0014-03	1
5	Power board assembly	950240012	PSA230D-A-0481-2N570B	1
4	Terminal board	950220559	TBP-VCB100-00-050000(GT M9603-US-TC)	1
3	Insulation plate	950239343	IPP-250209-00-PP0000	1
2	Bracket	950216233	BKP-BG55M10-00-000000	2
1	LCM	950240650	C650Y24-M10(QHM10GSTEL)	1
PC NO	PART NAME	R3	Supplier Description	QTY

Design	Check	Release	Author

EXPLODE VIEW

PTV 65GQU-5025C (数字)

page 1 total page

total no. of old base map

total no. of base map

signature date

format